



Ephesians 3:20-21

Now to him who is able to do far more abundantly than all that we ask or think, according to the power at work within us, to him be glory in the church and in Christ Jesus throughout all generations, forever and ever. Amen.

RISE
is about entrusting the
gospel to every
generation – building a
people following
Jesus, not just projects.

Together,
we rise to
carry
the mission of
Jesus
forward.





Westminster Family,

Over sixty years ago, thirteen families gathered with a vision for a church that would be faithful to God's Word and courageous for God's mission. Out of their prayers and sacrifice, Westminster Chapel was born. Since then, God has written a beautiful story here — children meeting Jesus, marriages restored, friendships formed, leaders raised up, and missionaries sent out. We are living in the fruit of their faith.

Now it is our turn. God is inviting us to rise into the next chapter of this story. RISE is not just a campaign — it is a season for us to seek the Lord together, to listen for His voice, and to step forward in bold faith. It is about more than buildings or programs. It is about people. It is about preparing Westminster to remain a place where every generation can encounter Jesus and be sent out in His name.

Westminster belongs to Jesus, and He is writing this story through all of us. RISE is our shared journey of faith, an opportunity to hear His call and respond together.

We believe this is a pivotal moment. God has placed us in one of the most influential regions in the world, where the nations have come to our doorstep. That is not by accident. It is by His design. The question before us is whether we will rise to meet this calling. Will we prepare Westminster for the generations to come? Will we invest in leaders who will carry the gospel further than we ever could? Will we strengthen families and create a culture of discipleship that reaches beyond our walls?

My prayer is that God would stir fresh faith in each of us. I pray that together we would not only dream about what could be, but also take the bold steps to see it become reality. May we be found faithful in this generation, just as those who came before us were faithful in theirs.

Together, let's rise.

In Christ,

Ryan and the Elders



Why

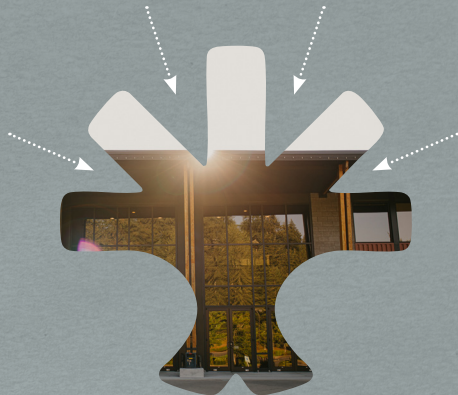

rise?

RISE is about more than buildings or budgets. It's about aligning Westminster around four kingdom priorities — each captured in one word:

Reimagine

our campus as a place of welcome, discipleship, and mission.

Invest

in leaders who will carry the gospel into the future.

Strengthen

the whole church family across generations.

Expand

our reach to a world God has brought to our doorstep.

Each of these priorities calls us beyond comfort and into vision. Together they form a pathway into the next season of Westminster's story.

Reimagine Our Campus for Generations



The spaces where we gather **matter.**

They communicate who we are, what we value, and how we welcome those God brings. Westminster has been blessed with a remarkable facility in a strategic place and after decades of faithful use, it is time to reimagine our campus for future generations.

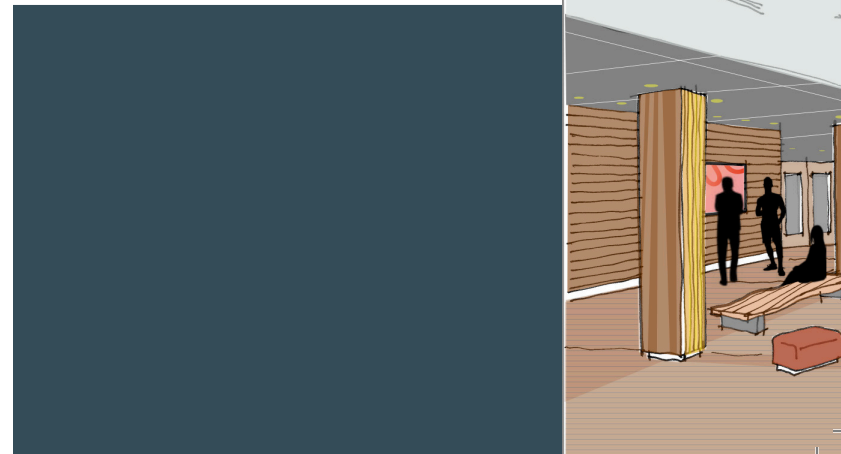
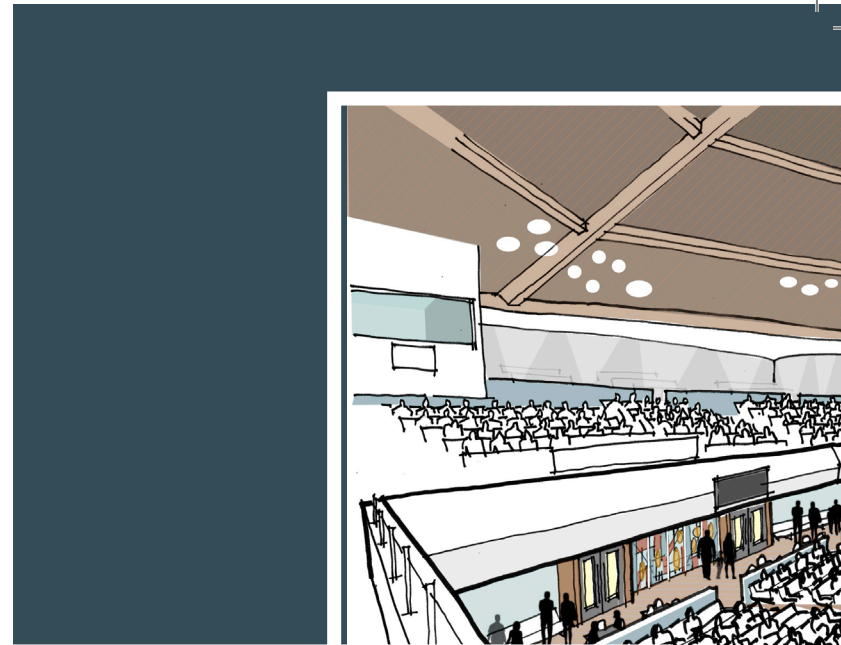

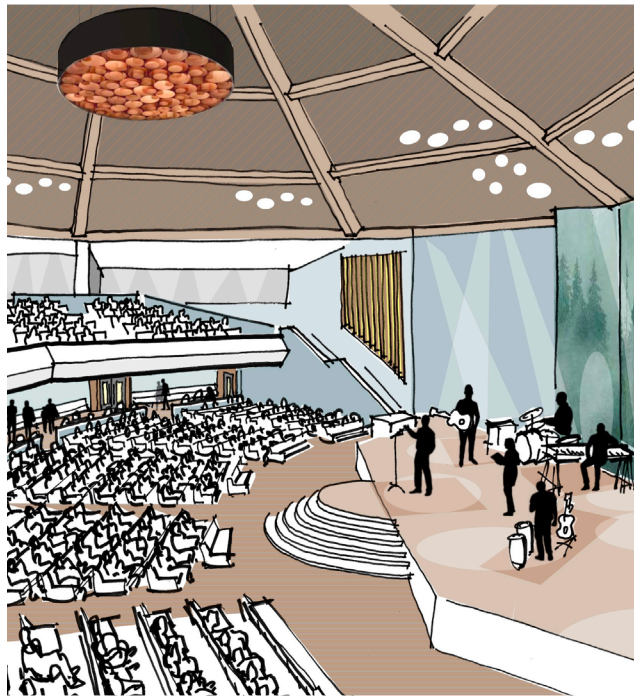

Strategic Outcomes



Perform essential renovations on the exterior and infrastructure: roof, windows, and building envelope.



Refresh the 300 level with beautiful, warm, and accessible gathering spaces.



Create modern children's ministry spaces with better wayfinding, lighting, and furnishings.



Add a new stairway connecting the 300 level to classrooms and ministry spaces for easier navigation.



Update the sanctuary with wider entrances, improved walkways, new furnishings, and modern technology for worship.



Renovate classrooms and gathering areas to foster discipleship, hospitality, and connection.

These improvements are about stewardship- we want our campus to reflect the warmth of Christ's welcome and to be a place that serves generations yet to come. By reimagining Westminster today, we pave the way for tomorrow's families, students, seekers, and disciples to find a spiritual home here.

rise

Invest in Future Leaders



The church is not built by programs or facilities but by people.

For Westminster to thrive into the future, we must be intentional about developing leaders — not just pastors, but everyday disciples equipped to serve in every sphere of life.

Strategic Outcomes



Launch a leadership pipeline with paid internships and residencies beginning in 2026.



Create training programs for pastors, church planters, and community leaders.



Equip existing lay leaders and group leaders with tools for continued growth.



Provide mentoring opportunities across generations so that leadership is always relational.

This investment is not only for students or young adults — it is for the whole church. We want to see leaders raised up in every season of life: parents discipling children, seniors and young adults caring for and sharpening one another, business leaders and community leaders serving their city with integrity, and pastors prepared for a lifetime of ministry. God calls us to equip the saints for the work of ministry (Ephesians 4:12), and RISE boldly trusts Him to provide the leaders Westminster and the world will need.



rise

Strengthen Families & Emerging Generations





The church is **not** an event or a building.

It is a family — God’s household — where every person has a place to belong, to grow, and to be sent. In this season, Westminster has an opportunity to strengthen every part of that family, from the youngest child to the oldest member, so that together we flourish in Christ.

Strategic Outcomes



Prioritize discipleship for children, students, college, and young adults.



Develop discipleship materials equipping toward our five Discipleship Roots: Worshiper, Learner, Connector, Giver, Witness.



Expand intergenerational communities so that everyone has a place of belonging.



Resource parents and families with tools to disciple at home.

Our children and students need more than programs — they need relationships, mentors, and communities that help them follow Jesus. Our adults need spaces of encouragement, accountability, and growth. Strengthening the church means doubling down on what matters most: discipleship that leads to transformation.

rise

Expand Our Reach



Bellevue and the Eastside are among the most globally connected regions in America

— a place where innovation and culture meet people from every nation. The world is at our doorstep. God has brought the nations here: tech leaders, immigrant families, students, and seekers from every background. Our calling at Westminster is not to turn inward, but to open our arms wider — to welcome, disciple, and send in the name of Jesus.



Strengthen partnerships with local ministries and global partners, meeting tangible needs in our city and throughout the world.



Send out future pastors and global mission partners.



Launch regular mission trips to build cross-cultural relationships and service opportunities.



Create environments that foster whole-life discipleship, not just Sunday faith.



Create new on-ramps for neighbors through community events and welcoming environments.

Expanding our reach is about lifting high the name of Jesus so that those who are far from God might find life in Him. God has placed us here, in this city, at this time, for this purpose. Together, we will rise to meet the opportunity at our doorstep.

RISE is not about equal gifts — it is about equal sacrifice. Every one of us has a part to play in what God is doing through Westminster. When each generation steps forward together, Westminster rises as one family in Christ.



This is more than a financial goal — it is a spiritual journey. We are asking every person to seek God in prayer:

“Lord, how are You calling me to give so that others may know You?”

Our desire is not just to raise funds, but to raise faith in our God.



What a Rise Commitment Looks Like

Our
3-Year Goal:
**\$7.5
Million**

Faith Step

Giving in a way that stretches you, requiring trust in God's provision.

One-Time Gift

An initial gift that accelerates the work and demonstrates bold faith.

Three-Year Commitment

A pledge above and beyond regular giving, spread out over 36 months.

A Whole-Church Effort

Children, students, singles, families, and seniors all united in one vision.



Why Commitments Matter

Through RISE we will reimagine spaces for generations to come, invest in leaders who will carry the gospel forward, strengthen discipleship at every stage of life, and extend Christ's love beyond our walls.

In years to come, may this moment be remembered as a season of radical transformation, deeper trust, and lasting impact — where Westminster rose together to reimagine, invest, strengthen, and expand for the sake of Christ.



Commitment Sunday

S A V E
T H E
D A T E

09.28.25

Sunday, September 28, 2025, begins a season of commitment of gifts and pledges through October 31, 2025. Together, we will bring our one-time gifts and three-year commitments before the Lord and declare:

**“Jesus, we trust
You with our future.
Together, we rise.”**



Ways to Give →

- 1 Bring or mail the enclosed commitment envelope to Westminster Chapel.
- 2 Scan the QR code or go to WCRise.com to complete your commitment online.



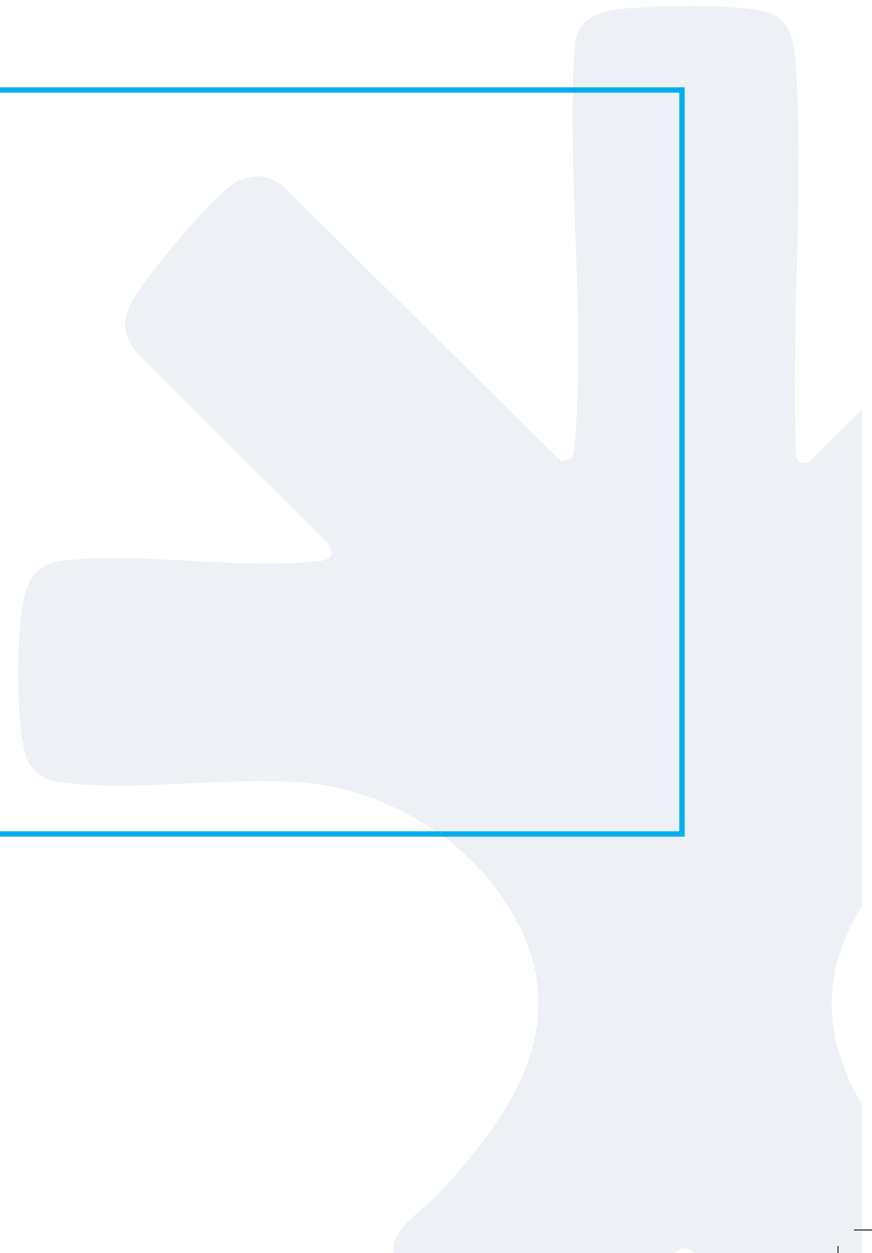

***rise**